

### 3. KEY FEATURES

#### 3.1 INTUITIVE LED CONTROL RING

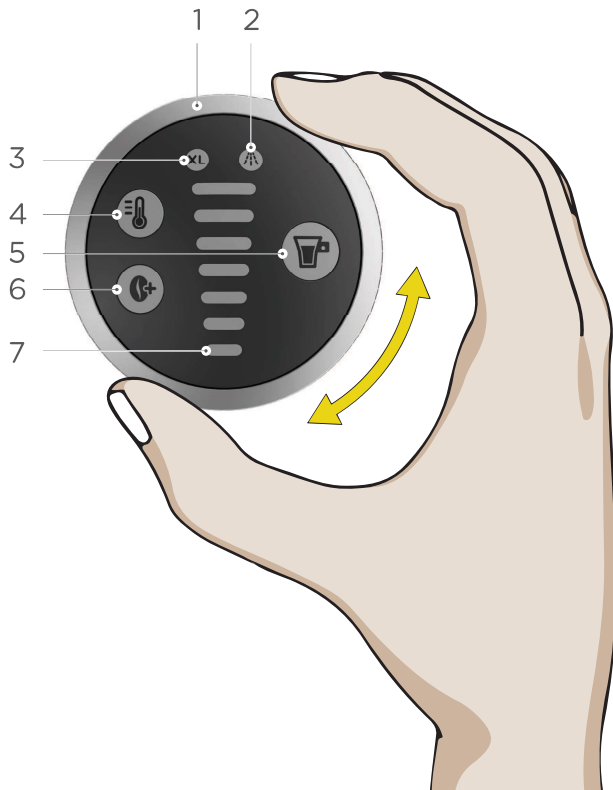

1. **Control ring**  
Select the volume for the beverage preparation
2. **Descaling indicator**  
The machine needs to be descaled after 300 extractions
3. **XL function**  
Prepare an extra large cup
4. **TEMPERATURE SELECTION**  
The beverage temperature can be set (4 predefined settings):

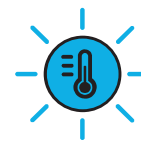
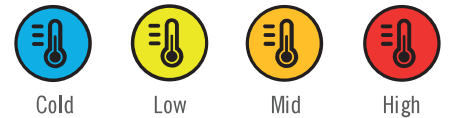

Cold, but the water temperature is still too high

5. **Start/Stop button**  
Start/Stop the beverage preparation
6. **ESPRESSO BOOST**  
Boost the taste intensity of your espressos
7. **Volume display**  
Shows the extraction progress by moving down from the selected volume until completion

#### 3.2 HOW TO START THE MACHINE

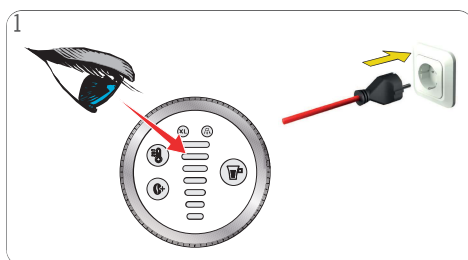

1 Ensure to use the correct mains voltage as given in 2. "MACHINE OVERVIEW" on page 6. Connect the power plug to the mains power socket.

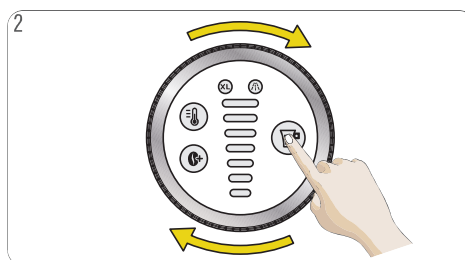

2 Press any button or rotate the control ring to start the machine.



3 The machine can also be switched on by opening the locking handle.



### 3. KEY FEATURES

#### 3.3 ESPRESSO BOOST



Boost the taste intensity of your Espressos.



#### ESPRESSO BOOST



ESPRESSO BOOST cannot be selected in cold mode. Do not use ESPRESSO BOOST with milk, chocolate and tea capsules.



1 Check the number of bars shown on the capsule. Prepare ESPRESSO BOOST for capsules identified with level 1, 2 & 3 only.

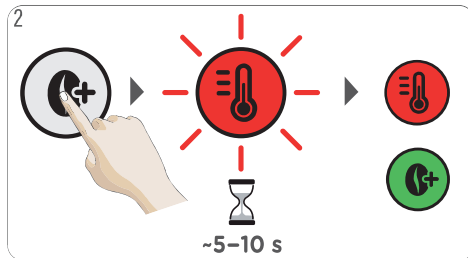

2 Press the ESPRESSO BOOST button to switch to ESPRESSO BOOST. The temperature selection button blinks while the machine is heating up for approximately 5–10 seconds. Afterwards, the temperature selection button lights steady red. The machine is ready to be used.



3 Use the control ring to set the volume in accordance with the number of bars shown on the capsule or select the desired volume to your own taste (max level 3).



4 Press the start/stop button. The beverage preparation starts. **Do not open the locking handle during the extraction.**

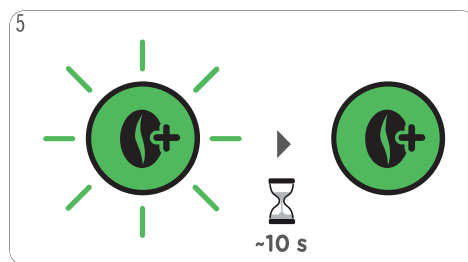

5 Pre-wetting: The preparation pauses and the ESPRESSO BOOST button starts blinking. After approx. 10 seconds the preparation continues and the ESPRESSO BOOST button is steady green. Wait until the machine stops automatically. The extraction can be stopped at any time manually by pressing the start/stop button.



6 Enjoy your beverage!

### 3. KEY FEATURES

#### 3.4 TEMPERATURE SELECTION



Customise the temperature of your coffees to your personal taste. The machine provides you with four predefined settings: cold, low, medium and high.



1 Check the number of bars shown on the capsule.

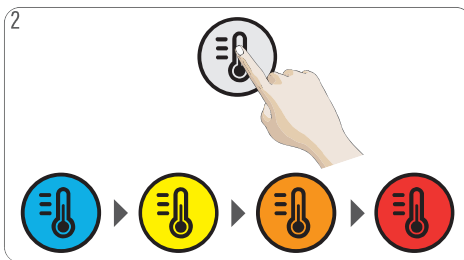

2 Press the temperature selection button to choose the desired temperature of your beverage.



3 Use the control ring to set the volume in accordance with the number of bars shown on the capsule or select the desired volume to your own taste.



4 Press the start/stop button. The beverage preparation starts. **Do not open the locking handle during the extraction.** Wait until the extraction stops. The machine stops the preparation automatically. The extraction can be stopped at any time manually by pressing the start/stop button.



5 After finishing the preparation, the temperature selection button and the volume display light blink for up to 8 seconds. **During that time do not open the locking handle!**



6 Enjoy your beverage!



### 3. KEY FEATURES

#### 3.5 COLD MODE

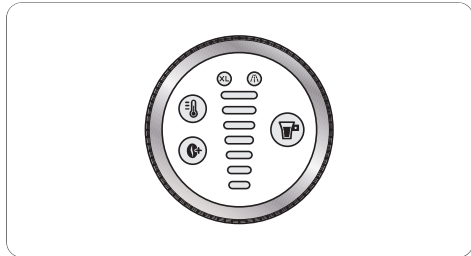

**Option A:** The machine is switched off.

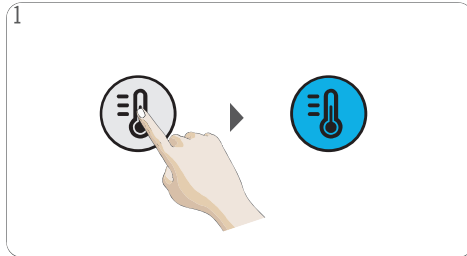

1 Press the temperature selection button to start the machine in cold mode. A cold beverage can be prepared immediately.

The cold mode must only be used with dedicated cold products, e. g. Cappuccino Ice.

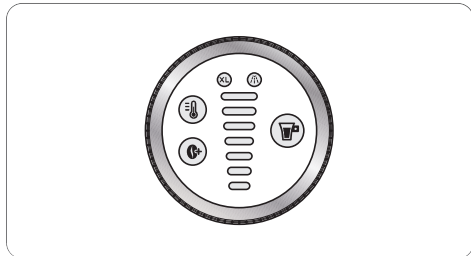

**Option B:** The machine is switched off.



1 Open the locking handle. The machine switches on automatically. Press the temperature selection button within 10 seconds after starting the machine to change to cold mode (blue). A cold beverage can be prepared immediately.

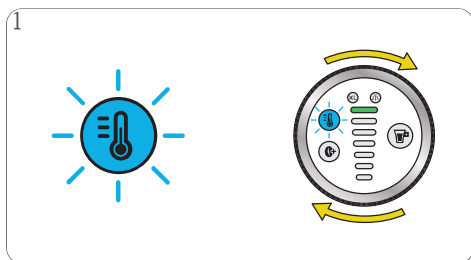

1 **Option C:** A hot beverage has been prepared or the cold mode was not selected within 10 seconds after starting the machine. Press the temperature selection button to go into cold mode. The temperature selection button will blink blue to indicate that the machine needs to cool down.

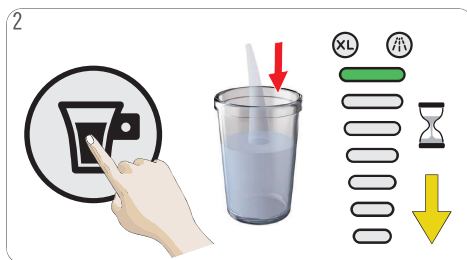

2 To accelerate the cooling, select level 7 on the volume display. Press the start/stop button. Machine starts rinsing. The volume display bar moves down until it disappears.

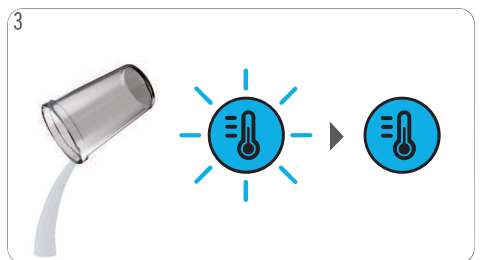

3 Empty the container. The temperature selection button is steady blue to indicate that the machine is cooled down and a cold beverage can be prepared.